



PARTITIONS CATALOGUE

NOROWALL

Al Hilal Bank, Abu Dhabi
 Al Jalila Children's Hospital, Dubai
 Al Sharaf Shipping, Dubai
 Apple Computer, Singapore
 Barclays Bank, London
 Bbc, London
 Bear Sterns, London
 Bmw Regional Head Quarter, Abu Dhabi
 Bnp Paribas, London
 Bp Mobil Oil Company, London
 Bp Petroleum, Singapore
 Bucharest Airport, Bucharest
 Cce Arcapita, Bahrain And Worldwide
 Citigroup, London
 Chase Manhattan Bank, London
 Doha Drug Store, Doha
 Emitac Mobile Solution, Dubai
 Empresa Municipal De Transporte, Madrid
 Ethiopian Central Bank, Addis Abeba
 First Islamic Inv. Bank, Bahrain I Atlanta Usa
 France Television, Paris
 Fm Global, Across Europe
 Fortis Bank, Across Nederland
 Glaxo Wellcome, London
 Ipc Media, London
 Katara Hospitality, Doha
 Kpmg, Sydney
 Library Of Alexandria, Alexandria
 London Borough Of Ealing, London
 Merrill Lynch Financial Centre, London
 Ministry Of Labour, Abu Dhabi
 Ministry Of Immigration, Jahra, Kuwait
 Ministry Of Immigration, Farwaniya, Kuwait
 Morgan Stanley, London
 National Bank, Abu Dhabi
 Nissan Renault, London
 Nueva Ciudad Judiciaria, Las Palmas Gc Spain
 Oxford University, Oxford
 Phillips Fox, Sydney
 Pierre Fabre Dermocosmetique, Toulouse
 Prada, New York
 Police Headquarter, Hawally, Kuwait
 Fastweb, Sedi Varie
 Ibm, Sedi Varie
 Lattebusche, Belluno
 Legrand, Milano
 Liebert Hiross, Padova
 Lingotto, Torino
 Mediaset, Milano
 Milano Serravalle, Milano
 Ospedale Di Brescia, Brescia
 Ospedale Di Mestre, Mestre
 Ospedale Di Udine, Udine
 Roma Metropolitane, Roma
 Schuco, Padova
 Sky Tv, Milano
 Sony, Milano
 Studio Altieri, Vicenza
 Università Di Padova, Padova
 Università Di Torino, Torino
 Vodafone, Sedi Varie

■ **Grandi progetti, a fianco dei migliori.**

La ricerca di nuove modalità stilistiche e funzionali, l'approdo ad un'ipotesi dinamica dell'organizzazione dell'ufficio, la voglia di dare forma a nuovi modelli di spazio in cui senso e funzione si compenetrano, in cui desideri e necessità pratiche si integrano. Sono questi i principi che muovono Nordwall, azienda che si distingue da oltre trent'anni nel design, nella progettazione e realizzazione di pareti mobili per ufficio e, recentemente, produttrice anche di arredi. Un consulente specializzato, capace di fornire un importante contributo all'interpretazione dello stile di ciascun edificio e suggerire soluzioni sintoniche. Proposte esclusive, anche su misura, dal design contemporaneo, realizzate con le più avanzate tecnologie per soddisfare al meglio tutte le più attuali esigenze organizzative dello spazio. Un know-how che ha reso possibile la partecipazione attiva a prestigiosi progetti edilizi, realizzati in partnership con i professionisti che hanno segnato la storia dell'architettura.

■ **Great projects, side-by-side with the best.**

The search for new stylistic and functional methods, reaching a dynamic way of organising your office, the urge to give shape to new space models where sense and function blend, where desires and practical needs integrate. These are the principles that drive Nordwall. For over thirty years, our company has made its mark in design, planning and building mobile walls for offices and, more recently, as a producer of furniture and furnishings. We are specialised consultants, who provide an important contribution to the interpretation of the style of every building, and suggest matching solutions. Exclusive proposals, tailor-made if necessary, achieved with the latest technologies to best satisfy all the most updated space organisation needs. This know-how has enabled us to actively participate in prestige building projects, implemented in partnership with professionals who have made their mark on architectural history.

■ **De grands projets, aux côtés des meilleurs.**

La recherche de nouvelles modalités stylistiques et fonctionnelles, l'approche d'une idée dynamique de l'organisation du bureau, l'envie de créer des formes pour de nouveaux modèles d'espace où l'inspiration et la fonctionnalité s'entremêlent et où les désirs s'intègrent aux nécessités pratiques. Il s'agit là des principes qui stimulent Nordwall, société qui se distingue depuis plus de trente ans dans le design, l'étude et la réalisation de parois mobiles pour bureau et qui, récemment, est également devenue productrice d'ameublement. Nordwall est un conseiller spécialisé, en mesure de fournir une contribution importante au niveau de l'interprétation du style de chaque édifice et de proposer des solutions harmonieuses. Des propositions exclusives, même sur mesure, au design contemporain, réalisées avec des technologies de pointe afin de satisfaire au mieux toutes les exigences actuelles d'organisation de l'espace. Un savoir-faire qui a permis une participation active à des projets de construction prestigieux, réalisés en partenariat avec les professionnels qui ont marqué l'histoire de l'architecture.

PARTITIONS CATALOGUE



IDEA partition system is made of single seamless glass panels, framed in aluminum structure, self-bearing, with independent construction components, fitted with polycarbonate sealing joints. These walls secure a good acoustic performance and provide a satisfactory clear-cut aesthetics, with the vertical and horizontal profiles on the perimeter connections.

The structural framing of IDEA system is available with two alternatives of ceiling channels, simple 36 mm. profile, or adjustable telescopic track, ceiling-mounted, with a range of +/- 15 mm. to compensate the deflection of floors and ceilings. The system is similar to NEXUS in its performance but it differs by the rounded shape of the ceiling telescopic track.









- **IDEA** - Sistema di pareti in vetro temperato monolastra da 10 o 12 millimetri di spessore e collegamenti verticali tra elementi vetrati con giunti brevettati in policarbonato trasparente. La struttura a pavimento e soffitto è costituita da canali telescopici in alluminio estruso che garantiscono il perfetto adattamento alle opere murarie. Nello sfondo la parete DIVA con moduli sviluppati in verticale e vetro acidato.
- **IDEA** - Single glazed partition system with 10 or 12 millimetre thick glass panels, and transparent polycarbonate dry joints. Floor and ceiling aluminium structure with extruded profiles to ensure perfect deflection and fixing to building structure. DIVA partition system with vertical full height panels and fritted glass in the background.
- **IDEA** - Système de cloisons vitrées en verre trempé de 10 à 12 millimètres d'épaisseur sans montants de structure, jonctions verticales entre les éléments vitrés à l'aide de joints brevetés en polycarbonate transparent. Profilés de lisse haute et basse télescopiques en aluminium extrudé, permettant une parfaite adaptation aux dimensions du bâtiment. Dans le fond, la cloison DIVA dans la version avec châssis vitrés verticaux à verre maté à l'acide.



■ Nelle foto di dettaglio:

- Foto 1.
Guida porta scorrevole a soffitto
- Foto 2.
Guida porta scorrevole a pavimento
- Foto 3.
Maniglione

■ The photos show:

- Detail 1.
Sliding door ceiling guide
- Detail 2.
Sliding door floor guide
- Detail 3.
Pull handle

■ Sur les photos de détail:

- Photo 1.
Rail porte coulissante au plafond
- Photo 2.
Glissière au sol de la porte coulissante
- Photo 3.
Tirant de porte

IDEA



- **IDEA** - Le porte della serie IDEA sono realizzate interamente in cristallo e prevedono la versione a battente con cerniere pivot e la versione scorrevole con guide a soffitto integrate al profilo telescopico.
- **IDEA** - Frameless glazed crystal doors can be pivoting or sliding with ceiling rails connected to the aluminium top track.
- **IDEA** - Les portes de la série IDEA sont entièrement réalisées en verre; elles comprennent la version porte battante sur pivots et la version coulissante avec glissière incorporée à la lisse haute telescopique.



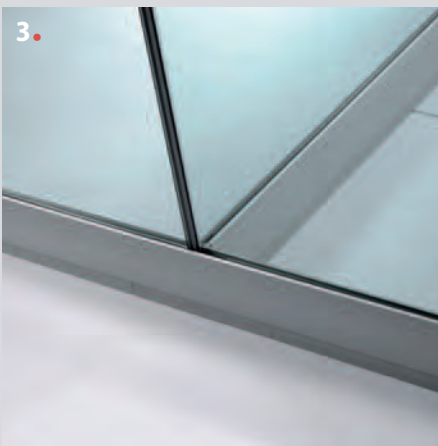
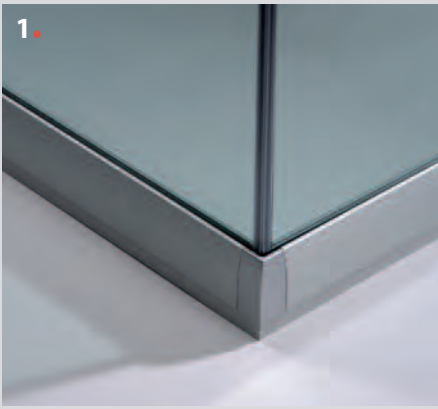

■ IDEA

- Foto 1 e 2. Angolo a 90°
vista esterna ed interna
- Foto 3 e 5. Angolo a tre vie
vista esterna ed interna
- Foto 4. Canalino a pavimento in
alternativa al canale
telescopico

■ IDEA

- Photo 1 and 2. 90° corner
internal and external detail
- Photo 3 and 5. Three way corner -
internal and external detail
- Photo 4. Alternative floor tracks

■ IDEA

- Photos 1 et 2. Angle à 90°
vues externe et interne
- Photos 3 et 5. Angle à trois voies
vues externe et interne
- Photo 4. Profilé de sol en
alternative à la lisse
télescopique

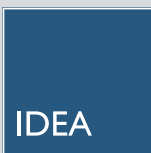

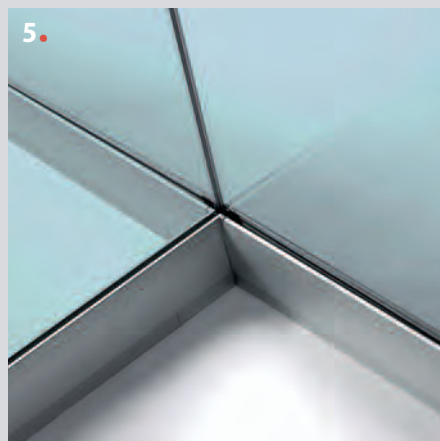
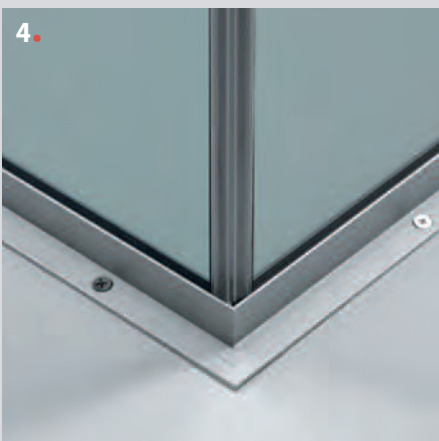
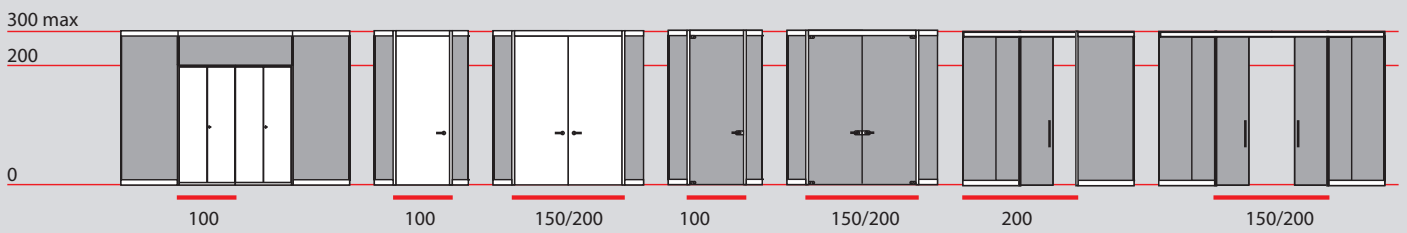
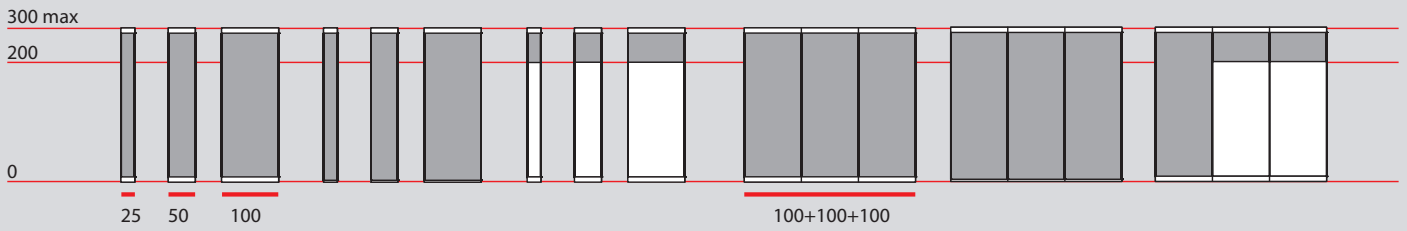
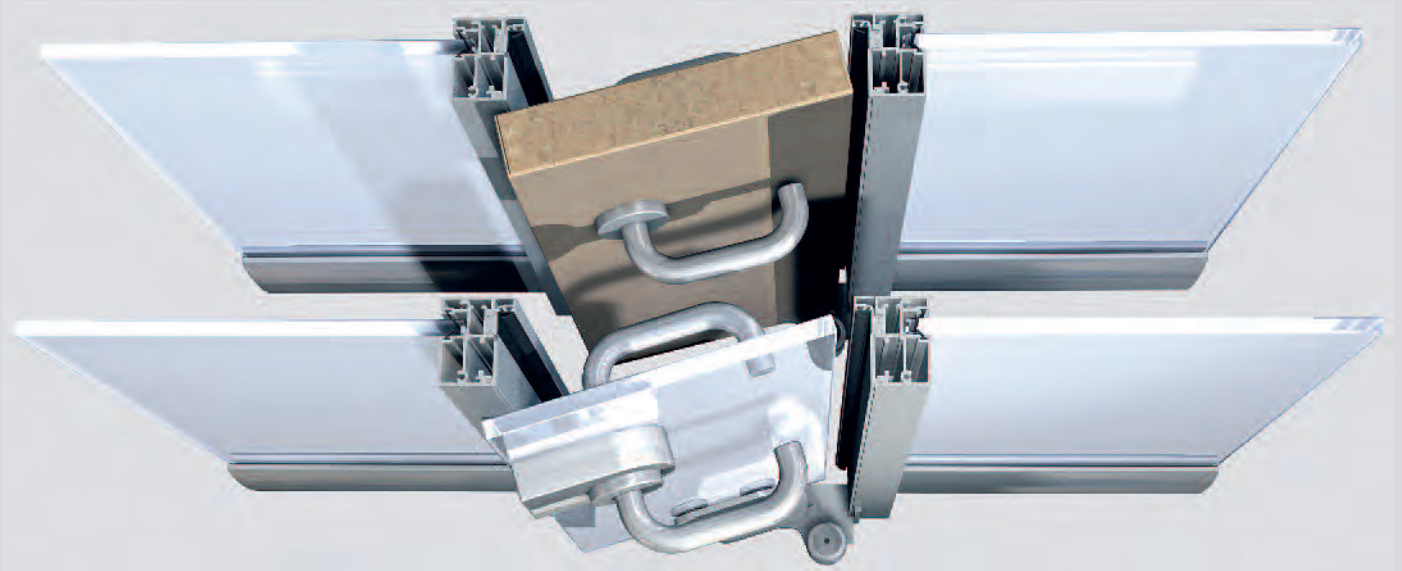

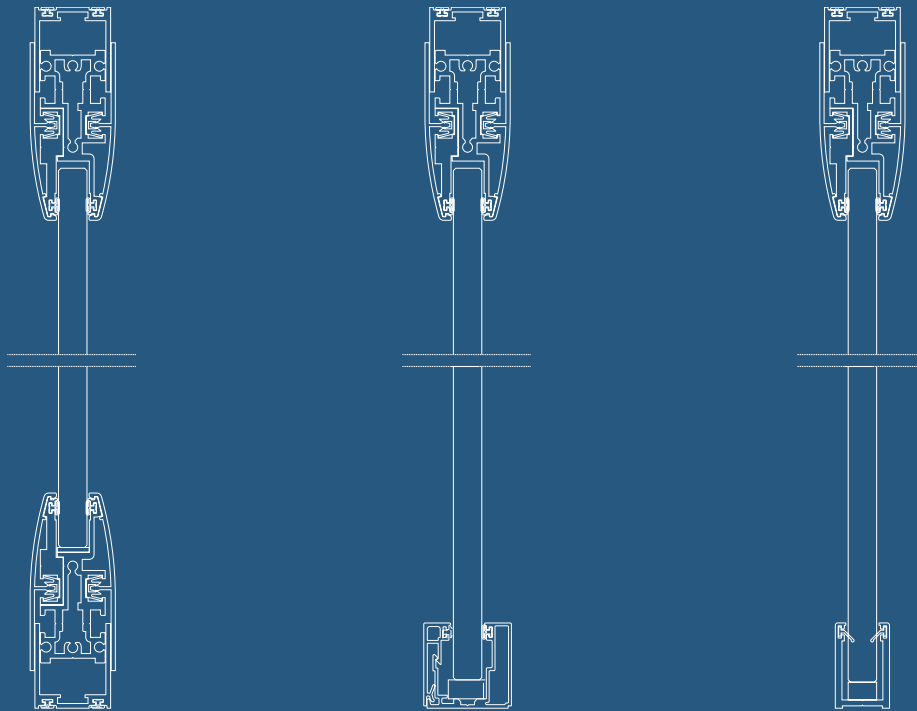

PRODUCT DESCRIPTION

IDEA partition system is made of single seamless glass panels, framed in aluminum structure, self-bearing, with independent construction components, fitted with polycarbonate sealing joints. These walls secure a good acoustic performance and provide a satisfactory clear-cut aesthetics, with the vertical and horizontal profiles on the perimeter connections.

The structural framing of IDEA system is available with two alternatives of ceiling channels, simple 36 mm. profile, or adjustable telescopic track, ceiling-mounted, with a range of +/- 15 mm. to compensate the deflection of floors and ceilings. The system is similar to NEXUS in its performance but it differs by the rounded shape of the ceiling telescopic track.

PRODUCT FEATURES AND CONSTRUCTION

IDEA Partition system, 36 mm. thick, is composed of one layer of 10 or 12 mm. glass panels, made of structural laminated glass or toughened glass, float or low iron, supplied accordingly to the project specifications.

The supporting glass holder, is made of pre-treated first grade aluminium, with the lower horizontal member fixed to the floor and the top channel, simple or adjustable telescopic track, connected to the glass panels are fitted in place, both sides, and are secured to the main frame with fixing covers. Vertical members, of the same section 36x36 mm., are required only at the start and at the end of the wall.

IDEA system doesn't provide upper adjustment or side panels adjustment. Each element is made to measure according to the needs of the construction site. The vertical joints connecting the modules and those on the corners, all in rigid transparent extruded polycarbonate, are fitted with a double strip of double-sided adhesive tape, to enable secure fixture to the panel elements. This joining system significantly improves structure stability and resistance to horizontal stress.

The door frames are made of pre-treated extruded aluminium, shaped to mount the panel elements, and perfectly assembled, are fitted with proprietary pivot hinges, handles and locks to specification. The door leaves, solid, single or double glazed, are fitted flush with the external surface of the wall. The perimetral coextruded gasket, provides the necessary acoustic requirement. Door frames can be fitted with a variety of accessories, door closers, drop seals, mag locks, electric strikes, card readers, etc.

TECHNICAL SPECIFICATIONS

Wall thickness	36 mm.
Maximum height	3000 mm. for full height glass panel
Width of modules	300 to 1500 mm.
Average weight	31 Kos. Per sq. meter

Telescopic ceiling track	90 mm (+/-15)
Floor track	36 mm.
Wall starter	36 mm.
Polycarbonate joiners	4 mm.

Glass thickness (toughened)	10 mm. 12 mm.
Laminated glass thickness	10,38 mm. 12,38 mm.
Acoustic laminated glass thickness	12,76 mm.
Toughened glass for door	12 mm.
Solid and double door leaf	45 mm.

Ceiling adjustment	+/- 10 mm. with telescopic track
Side/wall adjustment	+/- 10 mm.

NORDWALL HEADQUARTER

NORDWALL S.r.l.
Via Ruzzante 14,
35020 Sant'Angelo di Piove di S.
Padova - Italy
C.F. e P.I. 05172130287
Tel. +39 049 22 70 220
nordwall@nordwall.com
www.nordwall.com

NORDWALL Middle East

Engineering Carpentry Factory
BUILD 14, STREET 1, BLOCK 4,
AMGHARA INDUSTRIAL
PO Box : 3106 - Jahra 1033
3016 KUWAIT
Tel +965-2-24580084
meshari@eng-tech.biz

NORDWALL ROMA

GRAFITEC S.r.l.
Via Aurora 24,
00013 Fonte Nuova
Roma - Italy
Tel. + 06 905 0309

NORDWALL U.S.A.

U.S.A. HEADQUARTER
Miami FL, 33129
Tel +1 786 2352489
nordwall.usa@nordwall.com