

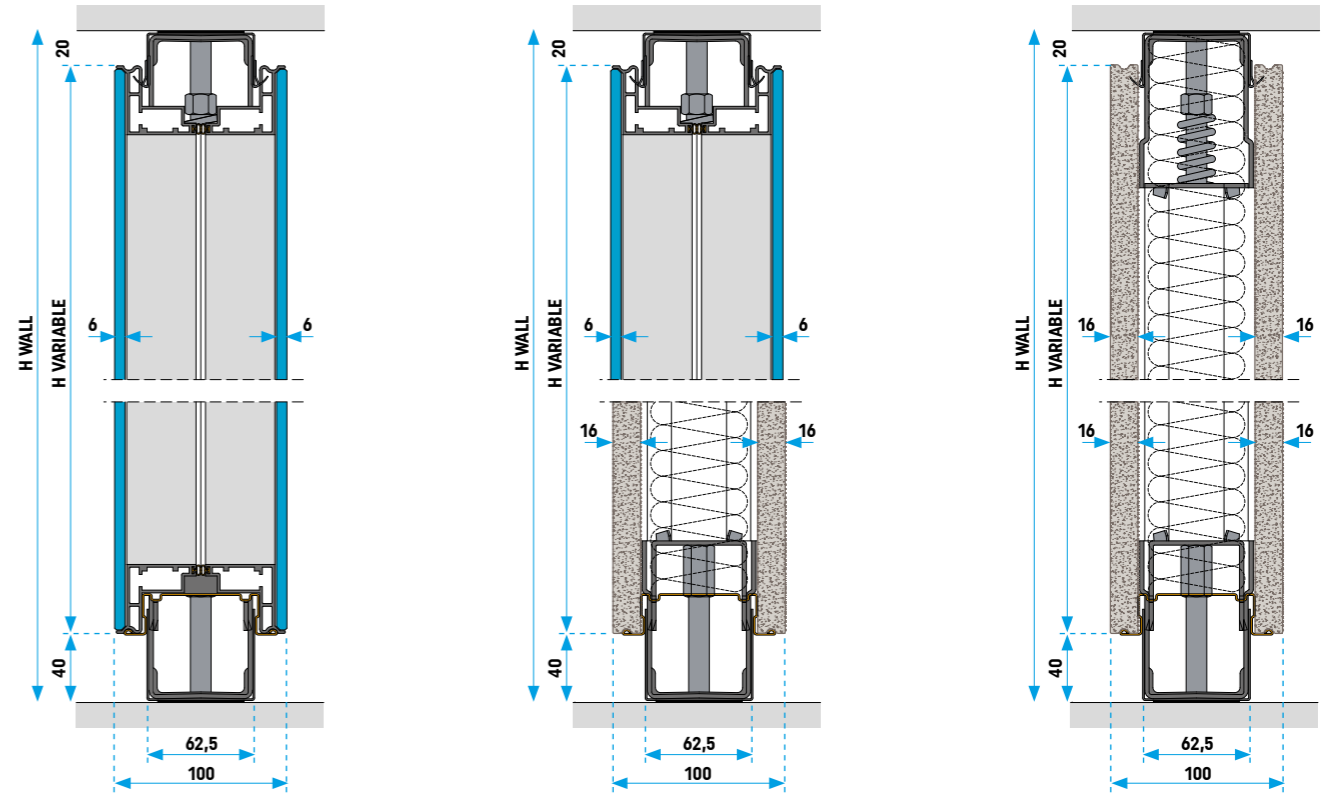

MODULAR DIVIDING WALL SYSTEM WITH CONTINUOUS GLASS SURFACE



LUCE Partitions is a system of mobile walls with internal steel-framed structure fitted with solid or glass panels, featuring an exclusive patented system to fit the panels and glass frames with a snap-on action that eliminates the use of hooks, screws, and clamps.

The LUCE system guarantees an excellent sound-proofing performance due to the accurate sealing of vertical and horizontal joints, significantly reducing noise and sound transmission, and the easy fitting of the solid or glazed panels on the two external sides.

The modular structure of DIVA system allows fast work for future reconfiguration of the office layout, with a limited waste of components and a "clean job overnight".

The modules remain totally re-usable, with no need for any alterations on-site. LUCE system is the elegant alternative to DIVA system with glass panels flush bonded to the aluminum frame. The bonding of the glass is made with 3M double side tape that guarantees adequate adhesion to the frame. The glass panels are shaped to be fitted to the mainframe and are complete with flexible gaskets in observance of current safety standards. This fitting method enhances the aesthetic effect of the continuous flush glass modules.

TECHNICAL SPECIFICATIONS

Wall thickness	100 mm
Maximum height	4500 mm
Width of modules	300 to 1500 mm
Average weight	33 Kos. Per sq. meter
Floor shadow line	40 mm (+/- 10 mm)
Ceiling shadow line	20 mm (+/- 10 mm)
Vertical pvc shadowline	11 mm
Glass thickness (toughened)	6 mm
Thickness of solid panels	16 mm
Toughened glass for door	10 mm
Solid and double glass door leaf	45 mm
Acoustic performance (noise reduction)	40 dB with solid panels only 47 dB with solid panels and rockwool 42 dB for glazed modules with 6 mm double glass
Acoustic performance for door	31 dB with solid door
Floor/ceiling adjustment	+/- 10 mm

CERTIFICATIONS

SOUNDPROOFING SOLID WITH DOOR 31 DB	SOUNDPROOFING SOLID WITHOUT ROCKWOOL 40 DB	SOUNDPROOFING OF A GLASS PANEL 42 DB	SOUNDPROOFING SOLID PANELS AND ROCKWOOL 47 DB
IMPACT TEST	ETA EUROPEAN TECHNICAL APPROVAL		